

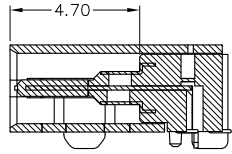

RoHS
Compliant
2002/95/EC

REV.	ECN.	NO.	APPD.

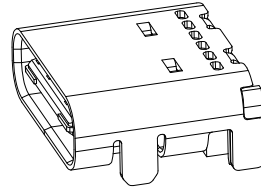
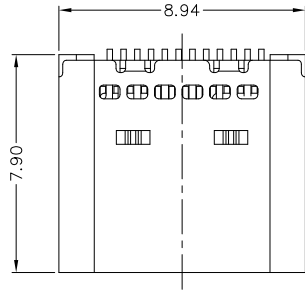

SECTION A-A

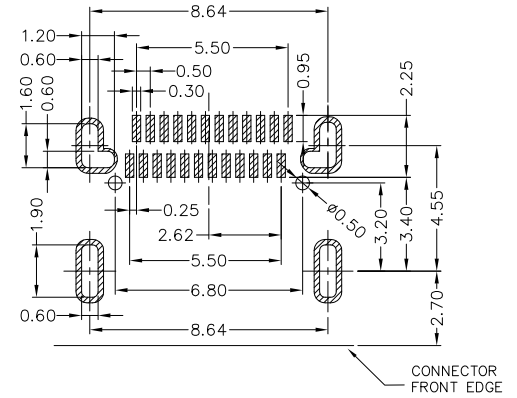
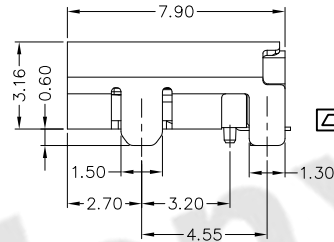
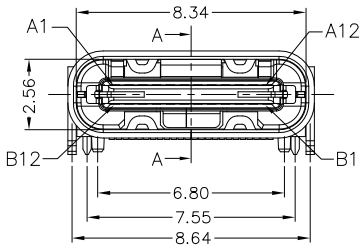

RECOMMENDED PCB LAYOUT

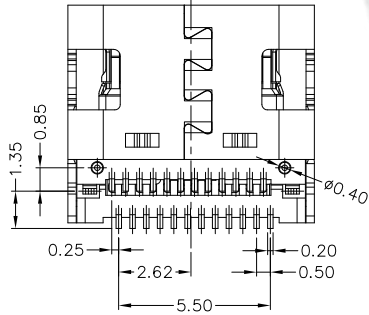

A1	GND	B12	GND
A2	SSTXP1	B11	SSRXP1
A3	SSTXN1	B10	SSRXN1
A4	VBUS	B9	VBUS
A5	CC1	B8	SBU2
A6	DP1	B7	DN2
A7	DN1	B6	DP2
A8	SBU1	B5	CC2
A9	VBUS	B4	VBUS
A10	SSRXN2	B3	SSTXN2
A11	SSRXP2	B2	SSTXP2
A12	GND	B1	GND
PIN	SIGNAL NAME	PIN	SIGNAL NAME

- NOTES:
- ELECTRICAL:
 - CURRENT RATING: 3AMP MAX;
 - INSULATION RESISTANCE: 100MΩ MIN 250V DC;
 - CONTACT RESISTANCE: 30mΩ MAX;
 - WITHSTANDING VOLTAGE: 250V AC;
 - OPERATING TEMPERATURE: -30°C TO +85°C.
 - Mechanical:
 - Mating Force: 5N~20N
 - Unmating Force: 8N~20N
 - DIMENSIONS MARKED " " TO BE CHECKED BY Q.C & IPQC.
 - PART NO. USCFC-24*N-4BV64

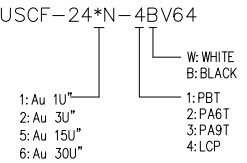

Bill of materials:

NO	PARTS	MATERIAL	QTY	FINISHING	UNITS	mm	东莞市腾兴电子有限公司						
5	SHRAPNEL	STAINLESS STEEL	1		X. ±0.35	X.' ±2'	SEE NOTE	TITLE: USB CF TYPE 双排 SMT 有柱		PART NO.: USCFC-24*N-4BV64			
4	HOOK	STAINLESS STEEL	1	PLATED TIN	.X ±0.3	.X' ±1'							
3	SHELL	STAINLESS STEEL	1	PLATED NICKEL	.XX ±0.25	.XX'							
2	TERMINAL	COPPER ALLOY	24	PLATED GOLD	.XXX ±0.15	.XXX'	SEE NOTE	DR: gan 2016/9/19		DWG NO.: All-V64			
1	HOUSING	LCP+30%GF	1	UL94V-0	THESE DRAWINGS AND SPECIFICATIONS ARE THE PROPERTY OF ACCURATE INNOTECH INC. AND SHALL NOT BE REPRODUCED, COPIED OR USED IN ANY MANNER WITHOUT THE PRIOR WRITTEN CONSENT OF ACCURATE INNOTECH INC.		Q'TY	CHKD: gan 2016/9/19		SCALE	SHEET	REV.	CUSTOMER DRAWING
NO	PARTS	MATERIAL	QTY	FINISHING				APPD:	1:1	1/1	B		