

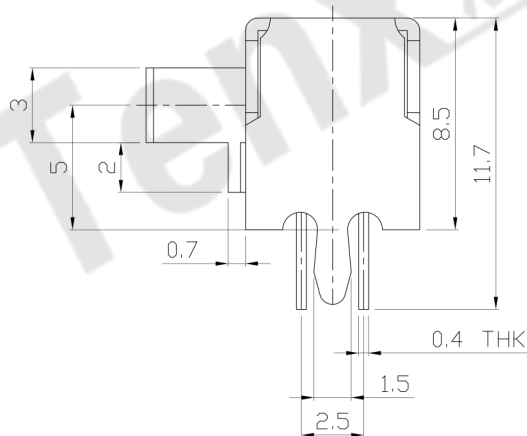

RoHS Compliant
2002/95/EC

| | | | |
|------|------|-----|-------|
| REV. | ECN. | NO. | APPD. |
| | | | |
| | | | |

DIMENSIONS

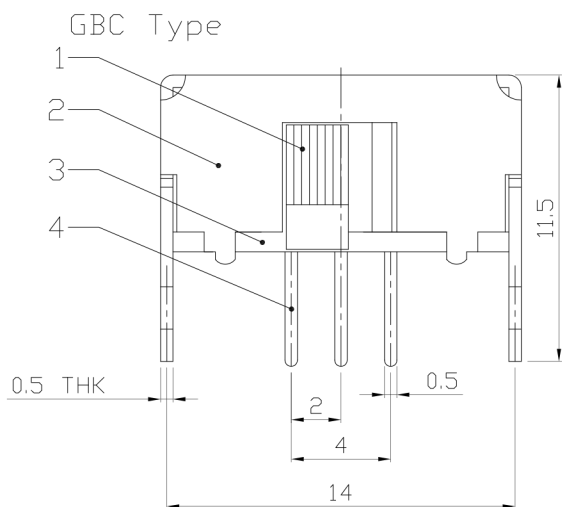
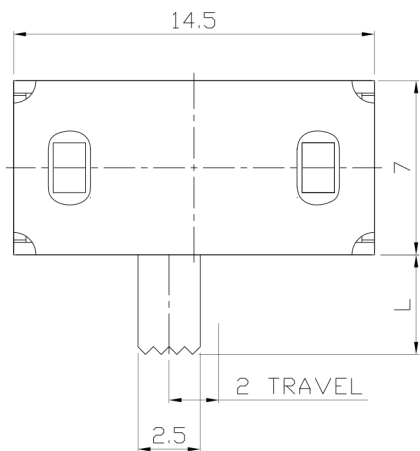

MODEL CODE

SK-22D15-GBC

| | |
|-----------|-------|
| Knob Type | L(mm) |
| GBC | ~ |

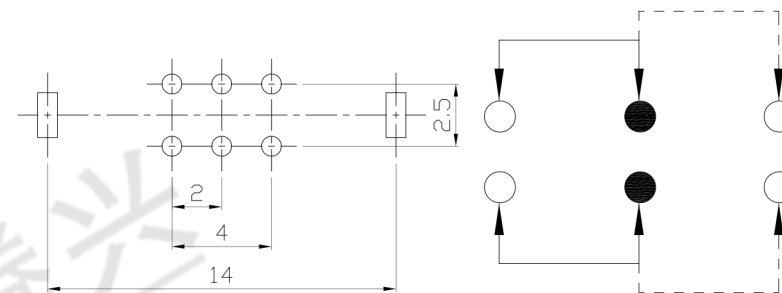

P.C.B LAYOUT
BOTTOM VIEW

CIRCUIT DIAGRAM

ELECTRO-MECHANICAL CHARACTERISTICS

Refer to additional specifications

| | |
|------------------------|--------------|
| RATING | 0.3A 50V DC |
| CIRCUIT | 2P2T |
| CONTACT RESISTANCE | 100mΩ MAX. |
| TIMING | NON-SHORTING |
| TRAVEL | 2mm |
| OPERATING FORCE | 350±100gf |
| OPERATING LIFE(cycles) | 10,000 |

| | | | | | |
|-----|--------------|----------------|------|-----------|----------------------|
| 8 | | | | | |
| 7 | | | | | |
| 6 | SPRING PLATE | SUS | 1 | NATURAL | WITHIN 1.5mm: ±0.1mm |
| 5 | CONTACT CLIP | PBS STRIP | 2 | Ag PLATED | OVER 1.5mm: ±0.2mm |
| 4 | TERMINAL | BRASS STRIP | 6 | Ag PLATED | |
| 3 | BASE | PHENOLIC RESIN | 1 | NATURAL | |
| 2 | FRAME | STEEL STRIP | 1 | Ni PLATED | |
| 1 | KNOB | POM | 1 | BLACK | |
| NO. | PARTS | MATERIAL | Q'TY | FINISHING | |

THESE DRAWINGS AND SPECIFICATIONS ARE THE PROPERTY OF ACCURATE INNOVATION INC AND SHALL NOT BE REPRODUCED, COPIED OR USED IN ANY MANNER WITHOUT THE PRIOR WRITTEN CONSENT OF ACCURATE INNOVATION INC.

UNITS mm

MAT'L SEE NOTE

FINISH SEE NOTE

Q'TY

东 莞 市 腾 兴 电 子 有 限 公 司

TITLE: SLIDE SWITCH / HORIZONTAL

DR: Ricky 2016/06/24

CHKD: Ricky 2016/06/24

APPD:

PART NO.: SK-22D15

DWG NO.: ADL-22D15

| | | | |
|-------|-------|------|------------------|
| SCALE | SHEET | REV. | CUSTOMER DRAWING |
| 3:1 | 1/1 | A | |