

RoHS
COMPLIANT

◆ SPECIFICATIONS

- Current rating: 2.5A AC, DC
- Voltage rating: 250V AC, DC
- Temperature range: -40°C ~ +105°C
- Insulation resistance: 1000M Ω Min.
- Withstanding voltage: 500V AC/ minute.
- Contact resistance: 20m Ω Max.

Material:

Insulator: PA6T UL 94V-0(2-10P)
LCP UL 94V-0(11-15P)

Contact: Brass

Plating: Tin plated or gold flash over Nickel

Suitable: KR1500 series Housing

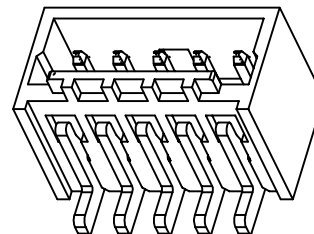

3D View

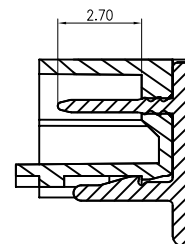
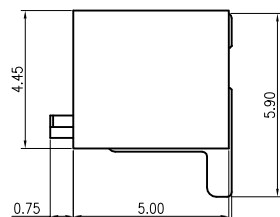
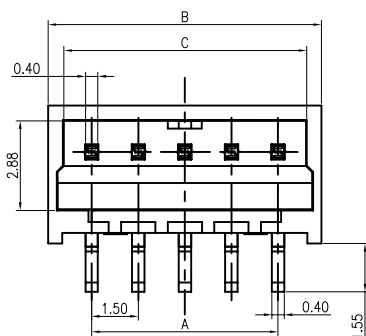

C1500VS1**09M0101RA
 02: 2P
 16: 16P
 09: PA6T本色
 13: LCP本色
 M01: 雾锡
 G01: 漂金
 R: 卷装
 P: 袋装

Dimensions			
Pin	A	B	C
2P	1.50	4.30	3.35
3P	3.00	5.80	4.85
4P	4.50	7.30	6.35
5P	6.00	8.80	7.85
6P	7.50	10.30	9.35
7P	9.00	11.80	10.85
8P	10.50	13.30	12.35
9P	12.00	14.80	13.85
10P	13.50	16.30	15.35
11P	15.00	17.80	16.85
12P	16.50	19.30	18.35
13P	18.00	20.80	19.85
14P	19.50	22.30	21.35
15P	21.00	23.80	22.85

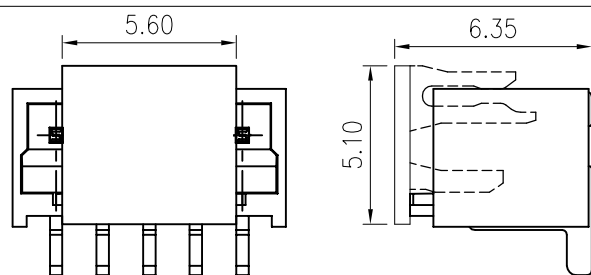

WITH CAP VIEW

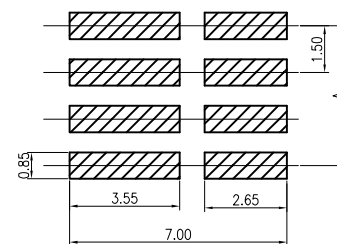

P.C.Board Layout

0.12 Max

A3	更改料号及图框格式	Ru yi	2020.3.10
A2	11-15P变更材质	Arvin	2019.03.13
A1	新发行	Arvin	2016.03.13
MARK	REVISION DESCRIPTION	SIGNATURE	DATE

TOLERANCE
 X.X ± 0.30
 X.XX ± 0.20
 X.XXX ± 0.10
 Angle $\pm 2^\circ$

TITLE:
 MX 1.5 SMT 180° Wafer
 UNIT: mm SCALE: N/A

DRAWN: ru yi 2020.03.10
 CHECKED:
 APPROVED:
 SHEET: 1/1 PROJECTION

东莞市腾兴电子有限公司

PART NO. : C1500VS1****M01**RA

REV. : A3 DRAWING NO. : 1500WS01-A-S