

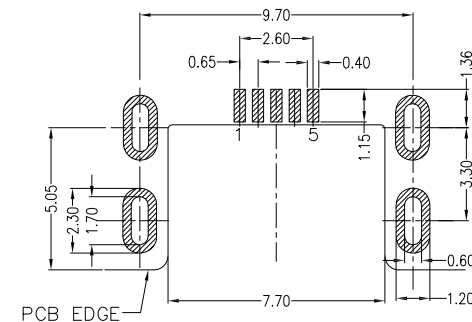

RoHS  
Compliant  
2002/95/EC

Halogen Free

| REV. | ECN. NO. | APPD. |
|------|----------|-------|
|      |          |       |
|      |          |       |

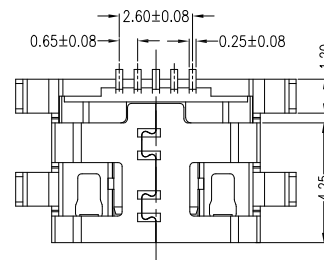
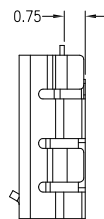
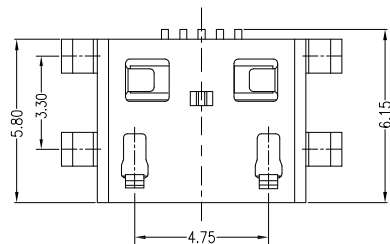
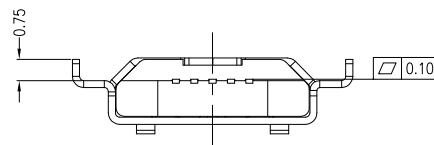

RECOMMENDED PCB LAYOUT

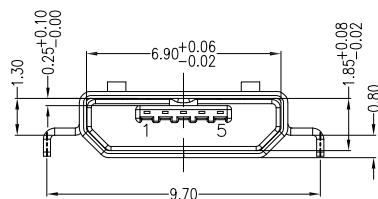

NOTES:

- ELECTRICAL:
  - VOLTAGE CURRENT RATING: PIN1&5 1.8AMP MAX / PIN2&3&4 1AMP MAX. ,30V AC;
  - INSULATION RESISTANCE: 100MΩ MIN;
  - CONTACT RESISTANCE: 30mΩ MAX;
  - WITHSTANDING VOLTAGE: 100V AC; FOR 1 MIN.
  - OPERATING TEMPERATURE: -30°C TO +80°C.
- Mechanical:
  - Mating Force: 35N MAX
  - Unmating Force: 10N MIN.
- DIMENSIONS MARKED "▼" TO BE CHECKED BY Q.C & IPQC.

4.PART NO.

MUYF-05\*T-4BHUA378  
 1:Au 1U\*  
 6:Au 30U\*  
 T:TIN  
 N:NICKEL  
 W:WHITE  
 B:BLACK  
 1:PBT  
 2:PA6T  
 3:PA9T  
 4:LCP

Bill of materials:

| NO | PARTS    | MATERIAL     | QTY | FINISHING   | UNITS  | mm      | 东莞市腾兴电子有限公司 |  |  |                                   |     |   |
|----|----------|--------------|-----|-------------|--|---------|-------------|--|--|-----------------------------------|-----|---|
| 3  | SHELL    | COPPER ALLOY | 1   | PLATED TIN  | X. ±0.35   | X.* ±2* | SEE NOTE    | TITLE: MICRO USB B TYPE F 5P SMT 沉板0.8 四脚全插无导位无孔 |  | PART NO.: MUYF-05XT-4BHUA378      |     |   |
| 2  | HOUSING  | LCP+30%GF    | 1   | UL94V-0     | .X ±0.30   | .X* ±1* |             | DR: Ricky 2018/9/5                               |  | DWG NO.: AII-HUA378               |     |   |
| 1  | TERMINAL | COPPER ALLOY | 5   | PLATED GOLD | .XX ±0.25  | .XX*    |             | CHKD: Ricky 2018/9/5                             |  | SCALE SHEET REV. CUSTOMER DRAWING |     |   |
|    |          |              |     |             | .XXX ±0.15   | .XXX*   |             | APPD:  |  | 5:1                               | 1/1 | A |
|    |          |              |     |             | THESE DRAWINGS AND SPECIFICATIONS ARE THE PROPERTY OF ACCURATE INDDTECH INC AND SHALL NOT BE REPRODUCED, COPIED OR USED IN ANY MANNER WITHOUT THE PRIOR WRITTEN CONSENT OF ACCURATE INDDTECH INC |         | Q'TY        |  |  |                                   |     |   |