

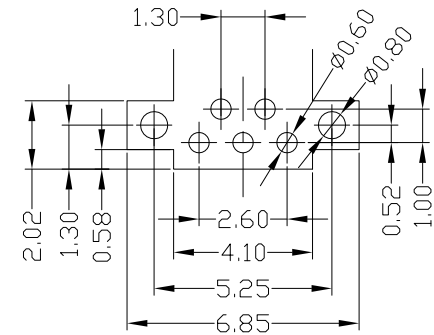

RoHS
Compliant
2002/95/EC

REV.	ECN. NO.	APPD.

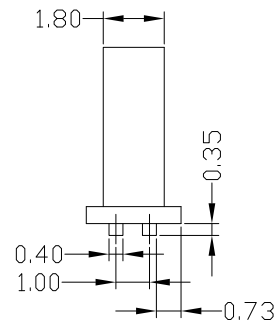
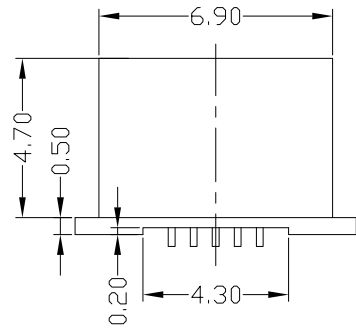
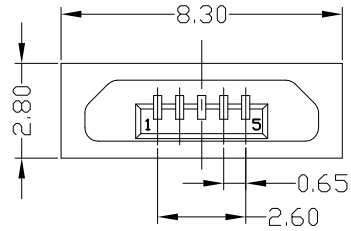

RECOMMENDED PCB LAYOUT

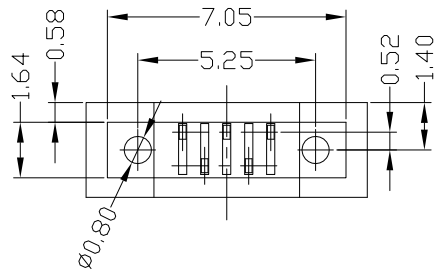

NOTES:

- ELECTRICAL:
 - VOLTAGE CURRENT RATING: 1.5AMP,250V AC;
 - INSULATION RESISTANCE: 1000MΩ MIN;
 - CONTACT RESISTANCE: 30mΩ MAX;
 - WITHSTANDING VOLTAGE: 500V AC;
 - OPERATING TEMPERATURE: -20°C TO +85°C.
- Mechanical:
 - Mating Force: 35N MAX
 - Unmating Force: 10N MIN.
- DIMENSIONS MARKED "▼" TO BE CHECKED BY Q.C & IPQC.

4.PART NO.

MUYM-05*0-1BPH10
 1:Au 1U*
 6:Au 30U*
 W:WHITE
 B:BLACK
 1:PBT
 2:PA6T
 3:PA9T
 4:LCP
 5:PA46

Bill of materials:

NO	PARTS	MATERIAL	QTY	FINISHING
2	HOUSING	PBT+30%GF	1	UL94V-0
1	TERMINAL	COPPER ALLOY	5	PLATED GOLD/TIN

X. ±0.3	X.' ±2'	UNITS mm
.X ±0.2	.X' ±1'	MAT'L
.XX ±0.15	.XX'	SEE NOTE
.XXX ±0.10	.XXX'	FINISH
<small>THESE DRAWINGS AND SPECIFICATIONS ARE THE PROPERTY OF ACCURATE INNOTECH INC AND SHALL NOT BE REPRODUCED, COPIED OR USED IN ANY MANNER WITHOUT THE PRIOR WRITTEN CONSENT OF ACCURATE INNOTECH INC.</small>		Q'TY

东莞市腾兴电子有限公司			
TITLE: Miro 5P 无线充头		PART NO.: MUYM-05*0-1BPH10	
DR: gan 2014/04/23		DWG NO.: AII-PH10	
CHKD: gan 2014/04/23		SCALE: 1:1	SHEET: 1/1
APPD:		REV.: B	CUSTOMER DRAWING