

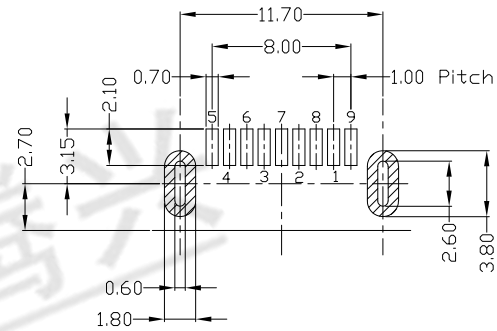

RoHS  
Compliant  
2002/95/EC

REV	LTR	DESCRIPTION	DATE	REVISER	APPD

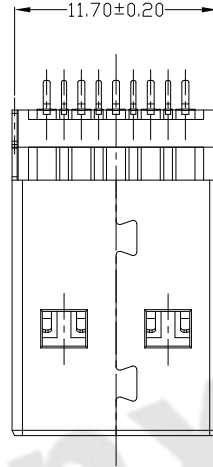
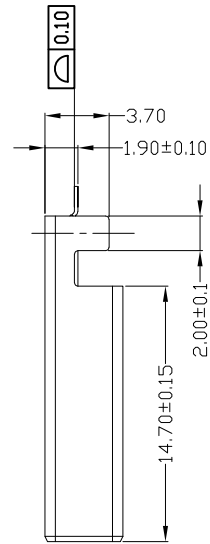
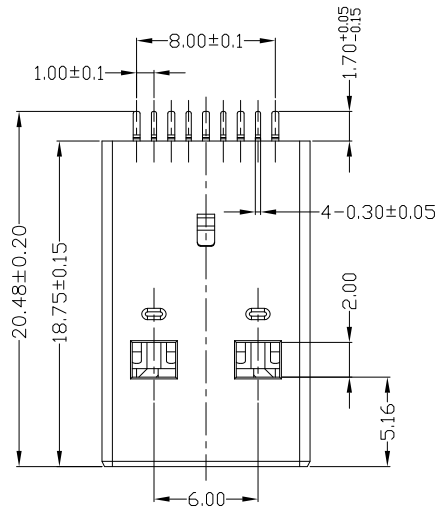

RECOMMENDED P.C.B LAYOUT

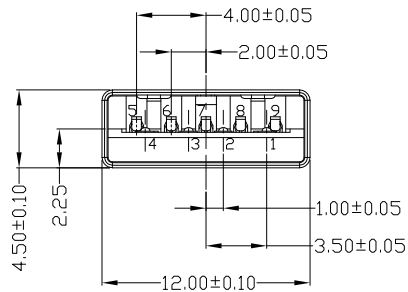
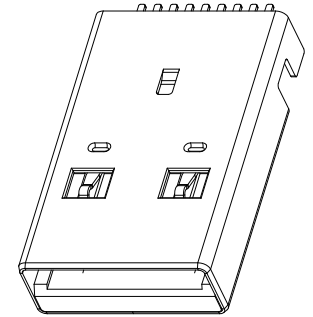

NOTES:

- ELECTRICAL:
  - VOLTAGE CURRENT RATING: 1.5AMP, 30V AC;
  - INSULATION RESISTANCE: 100MΩ MIN;
  - CONTACT RESISTANCE: 30mΩ MAX;
  - WITHSTANDING VOLTAGE: 500V AC;
  - OPERATING TEMPERATURE: -55°C TO +85°C.
- Mechanical:
  - Mating Force: 35N MAX
  - Unmating Force: 10N MIN.
- DIMENSIONS MARKED "▼"  
TO BE CHECKED BY Q.C & IPQC.

4. PART NO.

USAM-09\*N-4BLVU30

1Au 1U\*  
5Au 15U\*  
6Au 30U\*

1V-WHITE  
2-BLACK  
3-BL-BLUE  
1PBT  
2PA6T  
3PA9T  
4LCP

Bill of materials:

NO	PARTS	MATERIAL	QTY	FINISHING	UNITS	mm	东莞市腾兴电子有限公司					
3	HOUSING	LCP+30%GF	1	PLATED NICKEL	X. ±0.35	X.' ±2'	SEE NOTE	TITLE:		PART NO.:		
2	SHELL	SPCC	1	UL94V-0	.X ±0.3	.X' ±1'		USB AM 3.0 L=18.7MM 沉板1.9MM		USAM-09XN-4BLVU30		
1	TERMINAL	COPPER ALLOY	9	PLATED GOLD/TIN	.XX ±0.25	.XX'		无柱(外壳脚长3.70MM)锡脚1.7		DWG NO.:		
					.XXX ±0.15	.XXX'		DR: Ricky 2019/2/18		AII-VU30		
					THESE DRAWINGS AND SPECIFICATIONS ARE THE PROPERTY OF ACCURATE INNOTECH INC AND SHALL NOT BE REPRODUCED, COPIED OR USED IN ANY MANNER WITHOUT THE PRIOR WRITTEN CONSENT OF ACCURATE INNOTECH INC		Q'TY	CHKD: Ricky 2019/2/18	SCALE	SHEET	REV.	CUSTOMER DRAWING
								APPD:	1:1	1/1	B	