

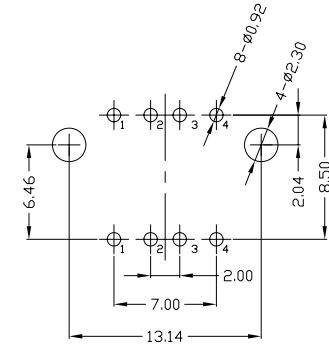

RoHS
Compliant
2002/95/EC

REV.	ECN.	NO.	APPD.

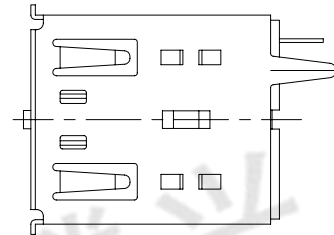
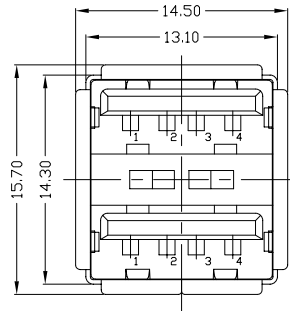
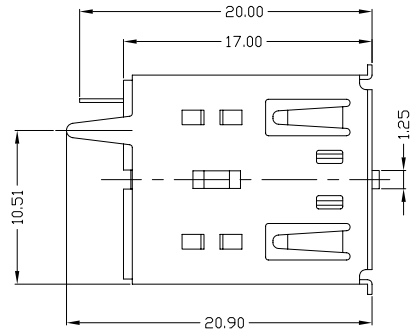

RECOMMENDED PCB LAYOUT

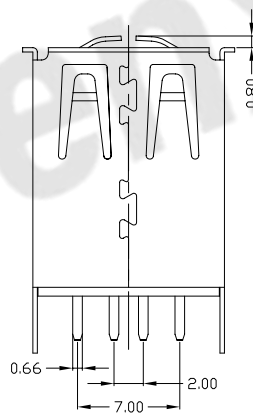

NOTES:

1. ELECTRICAL:
 - 1) VOLTAGE CURRENT RATING: 2AMP, 30V AC;
 - 2) INSULATION RESISTANCE: 1000MΩMIN;
 - 3) CONTACT RESISTANCE: 30mΩMAX;
 - 4) WITHSTANDING VOLTAGE: 500V AC;
 - 5) OPERATING TEMPERATURE: -55°C TO +85°C.
2. Mechanical:
 - 1) Mating Force: 35N MAX
 - 2) Unmating Force: 10N MIN.
3. DIMENSIONS MARKED "▼" TO BE CHECKED BY Q.C & IPQC.

4. PART NO.

USAF-08*N-1*P32

1: Au 1U'
6: Au 30U'

W: WHITE
B: BLACK

1: PBT
2: PA6T
3: PA9T
4: LCP

Bill of materials:

NO	PARTS	MATERIAL	QTY	FINISHING	X.	X.* ±2'	UNITS	mm	东莞市腾兴电子有限公司			
4	CLIP	COPPER ALLOY	1	PLATED NICKEL	X. ±0.35	X.* ±2'	MAT'L	SEE NOTE	TITLE:		PART NO.:	
3	HOUSING	PBT+30%GF	1	UL94V-0	.X ±0.3	.X.* ±1'	FINISH	SEE NOTE	USB AF 180° 双层插板长体(2直脚)		USAF-08*N-1*P32	
2	SHELL	COPPER ALLOY/SPCC	1	PLATED NICKEL	.XX ±0.25	.XX.*	Q'TY	SEE NOTE	DR: gan 2014/09/16		DWG NO.:	
1	TERMINAL	COPPER ALLOY	8	PLATED GOLD/TIN	.XXX ±0.15	.XXX.*	THESE DRAWINGS AND SPECIFICATIONS ARE THE PROPERTY OF ACCURATE INNO TECH INC AND SHALL NOT BE REPRODUCED, COPIED OR USED IN ANY MANNER WITHOUT THE PRIOR WRITTEN CONSENT OF ACCURATE INNO TECH INC.		CHKD: gan 2014/09/16		AII-P32	
NO	PARTS	MATERIAL	QTY	FINISHING			APPD:		SCALE	SHEET	REV.	CUSTOMER DRAWING
									1:1	1/1	B	