

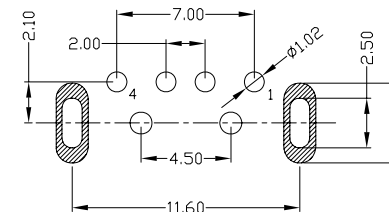

RoHS
Compliant
2002/95/EC

REV.	ECN.	NO.	APPD.

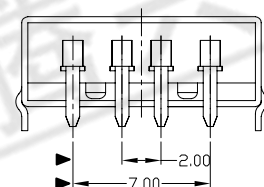
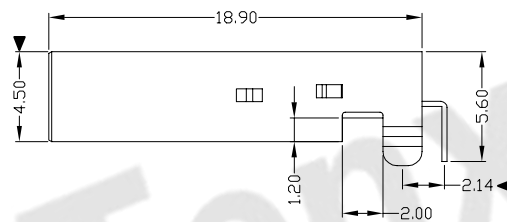
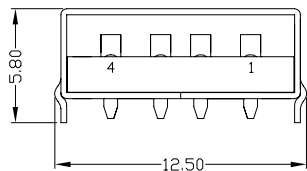
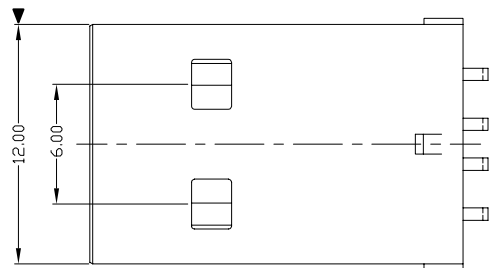

RECOMMENDED PCB LAYOUT

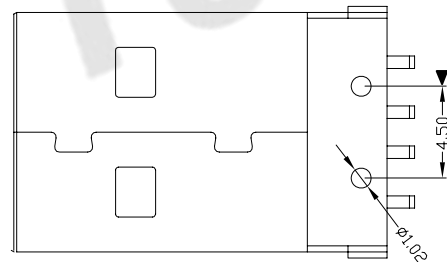

NOTES:

- ELECTRICAL:
 - VOLTAGE CURRENT RATING: 2AMP, 30V AC;
 - INSULATION RESISTANCE: 1000M Ω MIN;
 - CONTACT RESISTANCE: 30m Ω MAX;
 - WITHSTANDING VOLTAGE: 500V AC;
 - OPERATING TEMPERATURE: -55°C TO +85°C.
- Mechanical:
 - Mating Force: 35N MAX
 - Unmating Force: 10N MIN.
- NOTE: 1. DIMENSIONS MARKED "▼" TO BE CHECKED BY Q.C & IPQC.

4. PART NO.

USAM-04*N-1*R80

1Au 10"
6Au 30"
W: WHITE
B: BLACK
1PBT
2PA6T
3PA9T
4LCP

Bill of materials:

NO	PARTS	MATERIAL	QTY	FINISHING	UNITS	mm	东莞市腾兴电子有限公司							
3	HOUSING	PBT	1	UL94V-0	X. ± 0.35	X. $\pm 2^*$	TITLE:	USB A/M DIP 90° 弯脚 胶芯 1.2			PART NO.:	USAM-04*N-1*R80		
2	SHELL	SPCC	1	PLATED NICKEL	.XX ± 0.25	.XX*	DR:	gan 2012/7/03			DWG NO.:	AII-R80		
1	TERMINAL	COPPER ALLOY	4	PLATED GOLD/TIN	.XXX ± 0.15	.XXX*	CHKD:	gan 2012/7/03			SCALE	SHEET	REV.	CUSTOMER DRAWING
THESE DRAWINGS AND SPECIFICATIONS ARE THE PROPERTY OF ACCURATE INNOTECH INC AND SHALL NOT BE REPRODUCED COPIED OR USED IN ANY MANNER WITHOUT THE PRIOR WRITTEN CONSENT OF ACCURATE INNOTECH INC.					Q'TY	APPD:	1:1				1/1	B		