



RoHS
Compliant
2002/95/EC

REV.	ECN.	NO.	APPD.

USB TYPE-C 6P
RECEPTACLE INTERFACE PIN ASSIGNMENTS

B12	GND
B9	VBUS
B5	CC2
A5	CC1
A9	VBUS
A12	GND
PIN	SIGNAL NAME

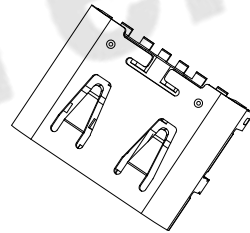
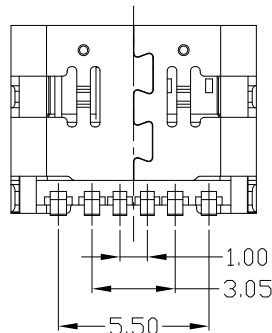
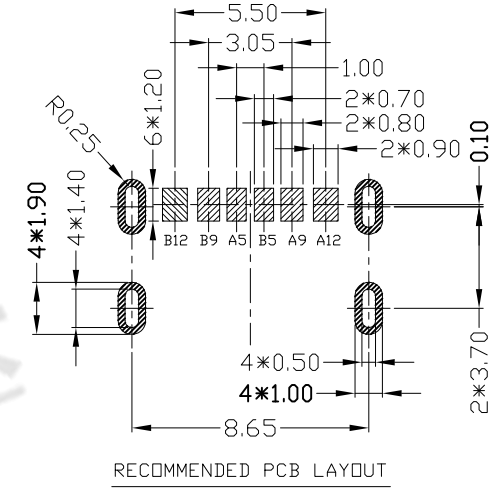
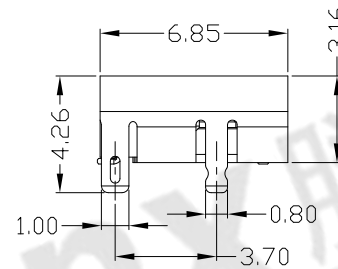
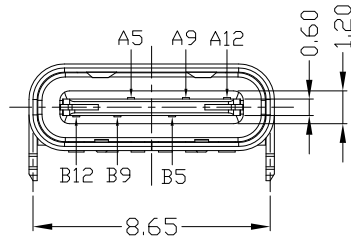
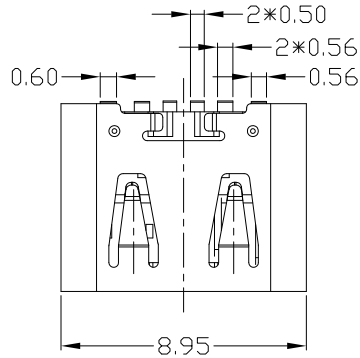

NOTES:

- ELECTRICAL:
 - CURRENT RATING: 5AMP MIN FOR VBUS; VOLTAGE RATING: 20VAC MAX
1.25A FOR GND PIN, 0.25A MIN FOR OTHER.
 - INSULATION RESISTANCE: 100MΩMIN;
 - CONTACT RESISTANCE: 40mΩMAX;
 - WITHSTANDING VOLTAGE: 100V AC;
 - OPERATING TEMPERATURE: -25°C TO +85°C.
- Mechanical:
 - INSERTION Force: 5~20N.
 - EXTRACTION Force: 8~20N.
- DIMENSIONS MARKED "▼" TO BE CHECKED BY Q.C & IPQC.

4. PART NO.

USCF-061N-4BVG30

1Au 1U*
2Au 3U*
5Au 15U*
6Au 30U*

W: WHITE
B: BLACK
1-PBT
2-PA6T
3-PA9T
4-LCP

Bill of materials:

NO	PARTS	MATERIAL	QTY	FINISHING	X. ±0.35	X.' ±2'	UNITS	mm	东莞市腾兴电子有限公司					
4	SHRAPNEL	STAINLESS STEEL	1	PLATED NICKEL	.X ±0.3	.X' ±1'	MAT'L	SEE NOTE	TITLE: USB TYPE CF 卧式SMT 6P L6.85mm		PART NO.: USCF-061N-4BVG30			
3	SHELL	STAINLESS STEEL	1	PLATED NICKEL	.XX ±0.25	.XX'	FINISH	SEE NOTE	DR: gan 2018/10/25		DWG NO.: AII-VG30			
2	TERMINAL	COPPER ALLOY	6	PLATED GOLD/TIN	.XXX ±0.15	.XXX'	Q'TY	SEE NOTE	CHKD: gan 2018/10/25		SCALE	SHEET	REV.	CUSTOMER
1	HOUSING	LCP+30%GF	1	UL94V-0	THESE DRAWINGS AND SPECIFICATIONS ARE THE PROPERTY OF ACCURATE INNOTECH INC AND SHALL NOT BE REPRODUCED, COPIED OR USED IN ANY MANNER WITHOUT THE PRIOR WRITTEN CONSENT OF ACCURATE INNOTECH INC.				APPD:		1:1	1/1	B	DRAWING