

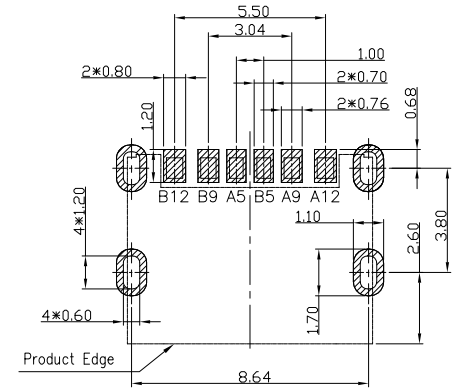

RoHS
Compliant
2002/95/EC

| REV. | ECN. | NO. | APPD. |
|------|------|-----|-------|
| | | | |
| | | | |

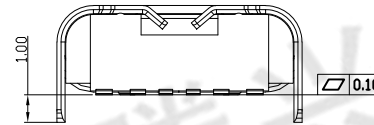
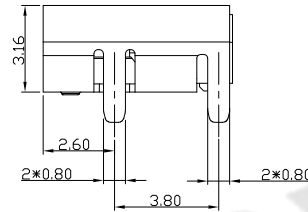
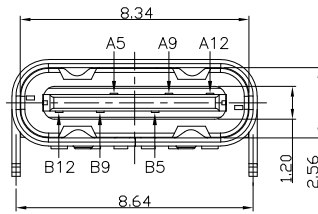
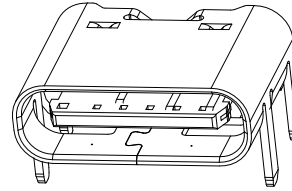
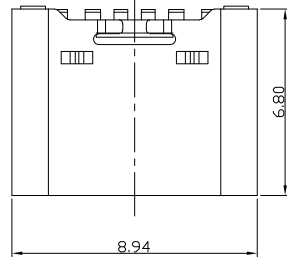

RECOMMENDED P.C.B. LAYOUT
TOLERANCE UNSPECIFIED ±0.05mm

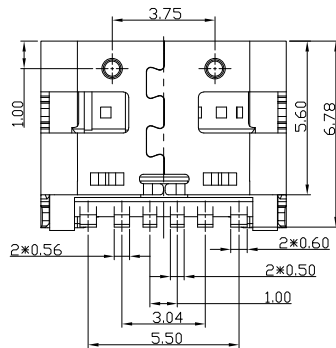

| | | | |
|-----|-------------|-----|-------------|
| A5 | CC1 | B12 | GND |
| A9 | VBUS | B9 | VBUS |
| A12 | GND | B5 | CC2 |
| PIN | SIGNAL NAME | PIN | SIGNAL NAME |

NOTES:

- ELECTRICAL:
 - CURRENT RATING: 5AMP MAX;
 - INSULATION RESISTANCE: 100MΩ MIN;
 - CONTACT RESISTANCE: 40mΩ MAX;
 - WITHSTANDING VOLTAGE: 100V AC;
 - OPERATING TEMPERATURE: -30°C TO +85°C.
- Mechanical:
 - Mating Force: 5N~20N
 - Unmating Force: 8N~20N
 - Durability: 10,000 cycles
- DIMENSIONS MARKED "▼"
TO BE CHECKED BY Q.C & IPQC.

4.PART NO.

USCF-06*N-4BVS207

1:Au 1U*
2:Au 3U*
5:Au 15u*
6:Au 30U*

W:WHITE
B:BLACK
1:PBT
2:PA6T
3:PA9T
4:LCP

| | | | | | | | |
|----|---------|-----------------|-----|------------|------------|----------|----|
| 5 | | | | X. ±0.35 | X.' ±2' | UNITS | mm |
| 4 | | | | .X ±0.30 | .X' ±1' | MAT'L | |
| 3 | SHELL | STAINLESS STEEL | 1 | .XX ±0.20 | .XX' ±0.5' | SEE NOTE | |
| 2 | CONTACT | COPPER ALLOY | 6 | .XXX ±0.10 | .XXX' | FINISH | |
| 1 | HOUSING | LCP+30%GF | 1 | | | SEE NOTE | |
| NO | PARTS | MATERIAL | QTY | FINISHING | | Q'TY | |

THESE DRAWINGS AND SPECIFICATIONS ARE THE PROPERTY OF ACCURATE INNO TECH INC AND SHALL NOT BE REPRODUCED, COPIED OR USED IN ANY MANNER WITHOUT THE PRIOR WRITTEN CONSENT OF ACCURATE INNO TECH INC



| | | | |
|---|--|--------------------------------|------------------|
| 东莞市腾兴电子有限公司 | | | |
| TITLE: USB C F TYPE 单排SMT 6PIN L=6.5 四脚插板 脚长1.0 | | PART NO.: USCF-06XN-4BVS207 | |
| DR: Ricky 2018/02/13 | | DWG NO.: AII-VS207 | |
| CHKD: Ricky 2018/02/13 | | SCALE | SHEET |
| APPD: | | 1:1 | 1/1 |
| | | REV. | CUSTOMER DRAWING |
| | | B | |