

RoHS
COMPLIANT

◆ SPECIFICATIONS

- Current rating: 3A AC, DC
- Voltage rating: 250V AC, DC
- Temperature range: -25°C ~ +85°C
- Insulation resistance: 1000MΩ Min.
- Withstanding voltage: 1000V AC/ minute.
- Contact resistance: 20mΩ Max.

Material:

Insulator: PA9T UL 94V-0
Contact: Brass
Plating: Tin plated over Nickel
Circuits: 2~16
Mates: KR2502 series Housing

Ordering code:

C2502RD1**11T0101PA

① ②

① Circuits: 102=2P 116=16P

② Material:

11:PA9T Natural

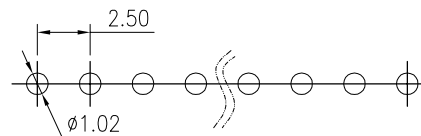

Recommended P.C.B. Layout
Total tolerance: ±0.05mm

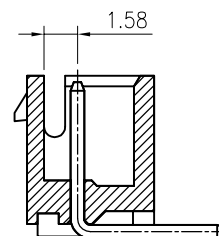
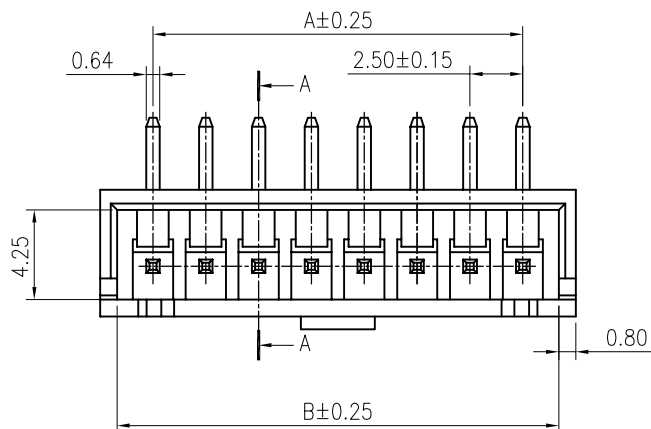

SECTION A-A

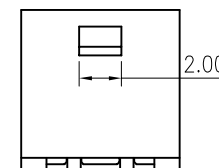
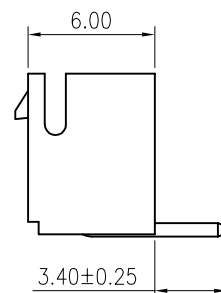
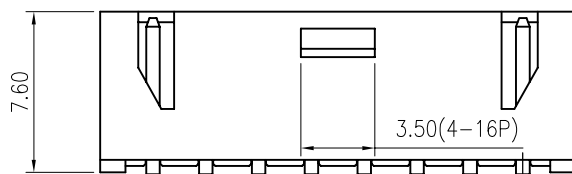

2 PIN

PIN NO.	DIMENSIONS	
	A	B
02P	2.50	5.90
03P	5.00	8.40
04P	7.50	10.90
05P	10.00	13.40
06P	12.50	15.90
07P	15.00	18.40
08P	17.50	20.90
09P	20.00	23.40
10P	22.50	25.90
11P	25.00	28.40
12P	27.50	30.90
13P	30.00	33.40
14P	32.50	35.90
15P	35.00	38.40
16P	37.50	40.90

△3			
△2			
△1	更改料号及图框格式	Arvin	2020.01.16
LTR	REVISION DESCRIPTION	SIGNATURE	DATE

TOLERANCE		TITLE:		DRAWN: 谭亮雄2020.01.16	
X.X	±0.30	XH2.5带扣 DIP 90°		CHECKED:	
X.XX	±0.20	WF		APPROVED:	
X.XXX	±0.10	UNIT: mm SCALE: N/A		SHEET: 1/1 PROJECTION	
Angle	±2°				

东莞市腾兴电子有限公司	
PART NO.: C2502RD1**11T0101PA	
VER.: A1	DRAWING NO.: 2502WRD101-A-S